

# SHOTGUN BLAST ZOMBIE

## INSTALLATION AND OPERATING INSTRUCTIONS

KEEP ALL PLASTIC AND WIRE PARTS AWAY FROM CHILDREN

- PARTS**
1. **BODY**
  2. **MODULE**
  3. **ADAPTER**
  4. **FRONT FOOT WITH WEIGHT**
  5. **SIDE FEET**
  6. **BACK FOOT**
  7. **BOTTOM POLE**
  8. **TOP POLE**
  9. **FOOT REMOVAL KEY**
  10. **ZOMBIE BLASTER**

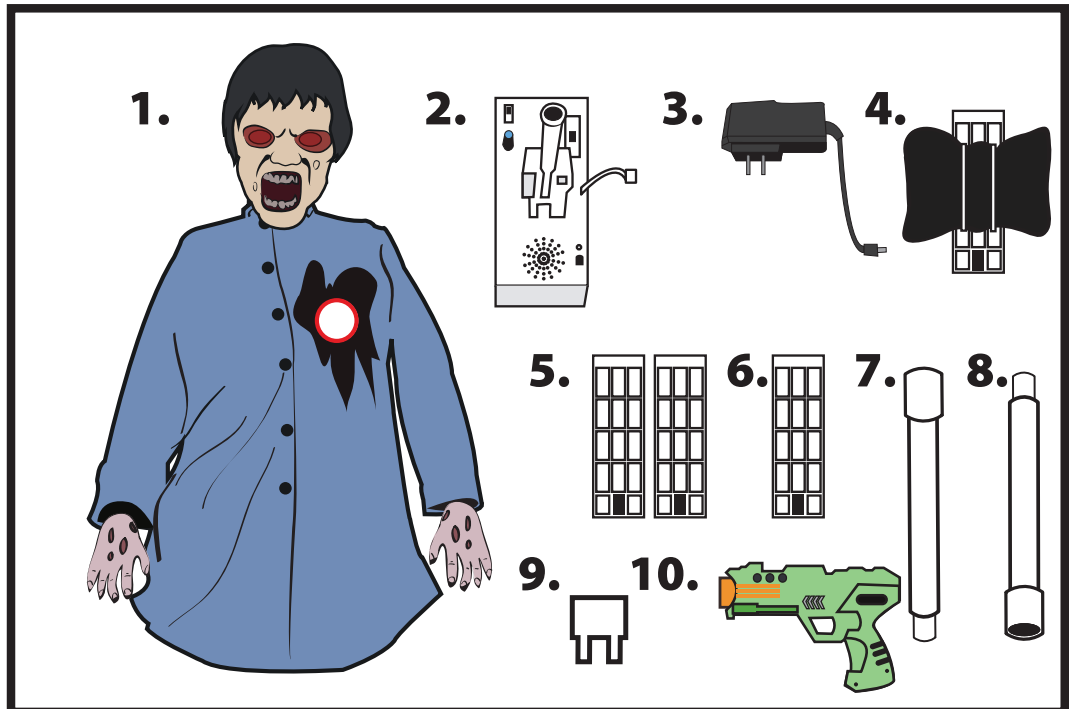

1. Insert **BACK FOOT AND SIDE FEET** into the bottom of **MODULE**.  
(Match C to C) (Match B to B) Snap to lock.

\* **IMPORTANT:** Press to make sure each **FOOT** is flush with **MODULE**.  
To remove **FOOT**, insert plastic **PLASTIC FOOT REMOVAL KEY**  
(included) into holes on bottom to release locks, twist and pull.  
To avoid damage do not pick item up while **FRONT FOOT** is attached.

2. Insert **FRONT FOOT WITH WEIGHT** into the bottom of the **MODULE**.  
(Match A to A)

3. Insert **BOTTOM POLE** into the **MODULE**.  
(Match D to D) Snap to lock.

4. Insert **TOP POLE** into the **BOTTOM POLE**.  
(Match E to E) Snap to lock.

5. Attach **BODY** to **TOP POLE**.  
(Match F to F) Snap to lock.

6. Insert wire from underneath clothing into wire coming  
from **MODULE**.  
(Match G to G)

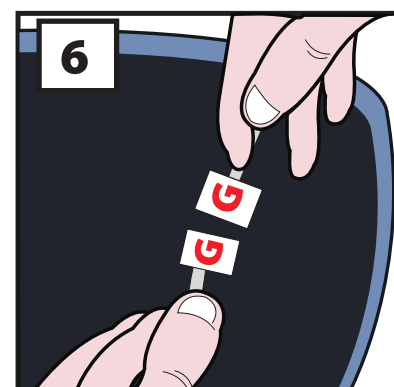
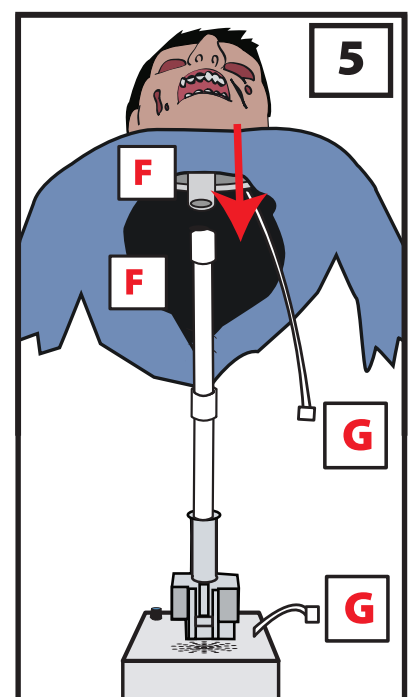
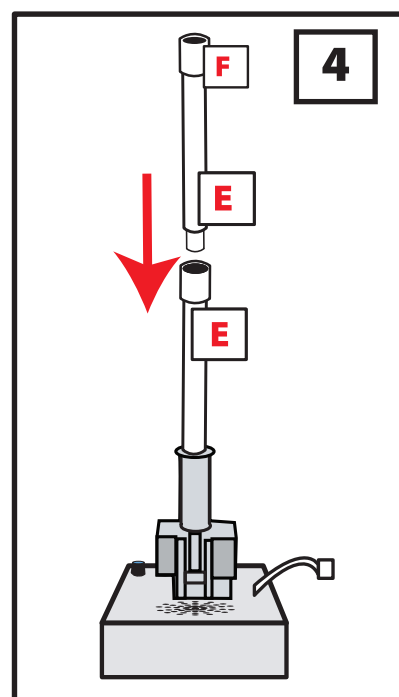
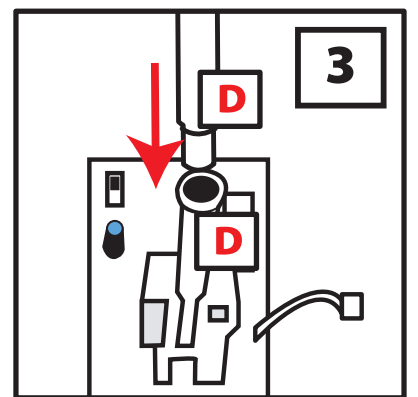
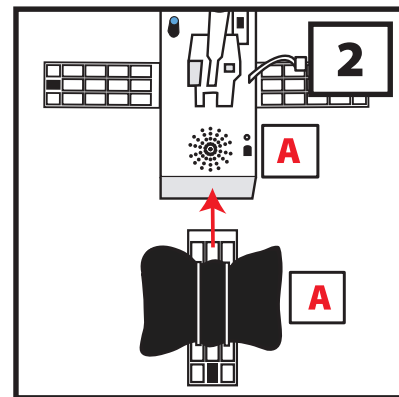
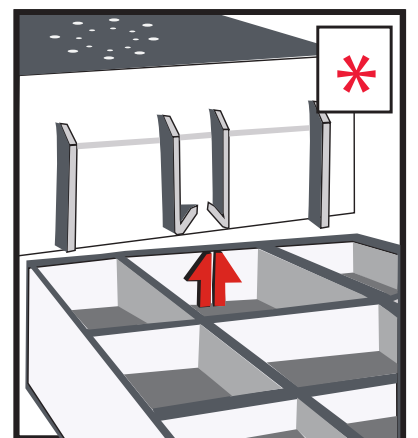
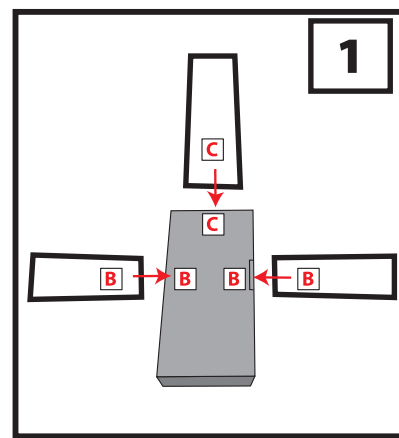

7. Connect 6V2A **ADAPTER** or insert 4 AA alkaline batteries into the battery compartment located on the top of the **MODULE**.
8. Turn switch on top of **MODULE** to **SENSOR** to operate in Sound activation mode. Make a loud sound (clap) to activate. Turn switch to **ON** to activate **SHOTGUN BLAST ZOMBIE** with **ZOMBIE BLASTER**.
9. Attach hook and loop located underneath clothing to **FRONT FOOT WITH WEIGHT** and **BACK AND SIDE FEET**.

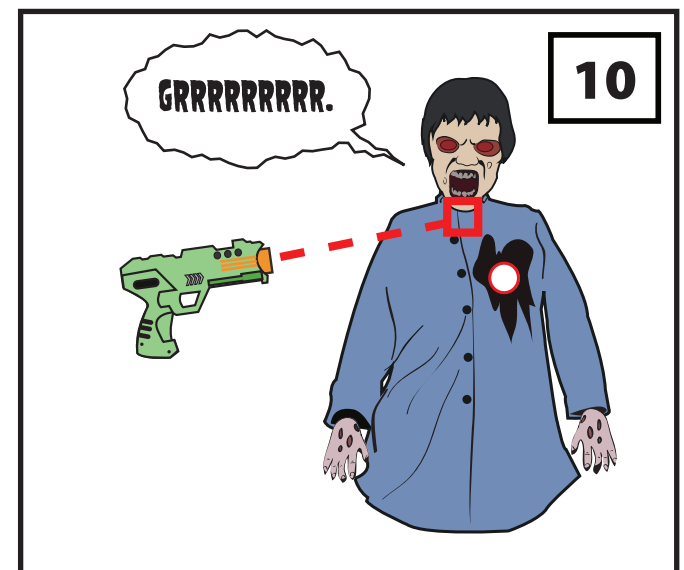
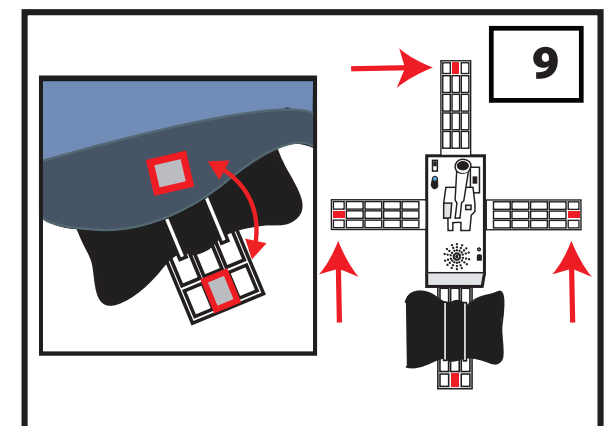
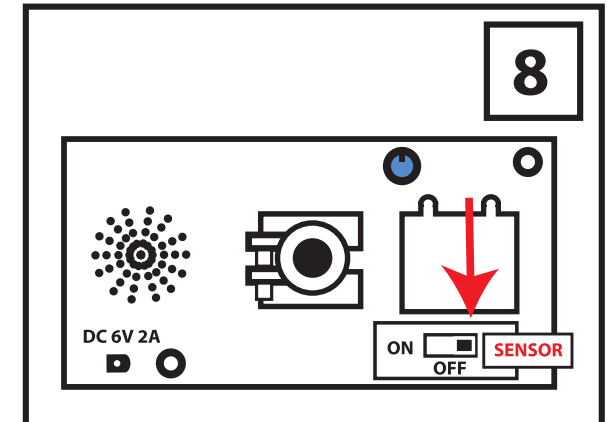
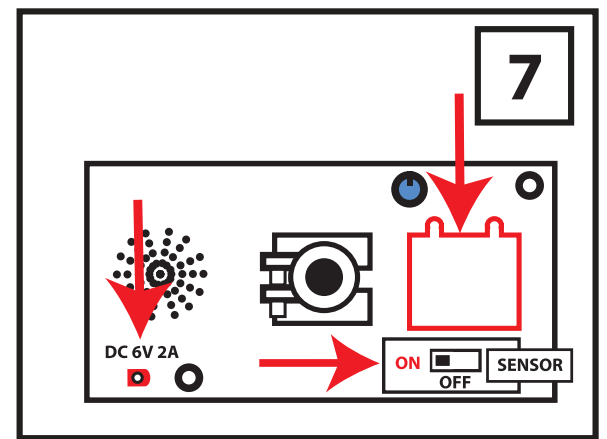

**ZOMBIE BLASTER BATTERY PLACEMENT**  
INSERT 2 AAA BATTERIES (NOT INCLUDED)

**IMPORTANT:**  
BATTERY COVER MUST BE COMPLETELY SCREWED DOWN SO THE COVER RESTS FLAT WITH THE HANDLE.

**WARNING!** USING OR MODIFYING THE ZOMBIE BLASTER IN ANY WAY BUT FOR WHICH IT IS INTENDED MAY BE UNLAWFUL AND PUNISHABLE BY LAW. This product may be mistaken for a firearm by law enforcement officers or others. Altering the coloration or markings required by state or federal law or regulations so as to make the product look more like a firearm is dangerous, and may be a crime. Brandishing or displaying the product in public may cause confusion and may be a crime.

10. Point the **ZOMBIE BLASTER** at **SHOTGUN ZOMBIE**. Pull trigger to activate!

For optimal function, point the **ZOMBIE BLASTER** at the sensor located near the top button on shirt. Adjust button or shirt as needed if item does not trigger properly. Button sensor **MUST** be facing straight forward.

**WARNING:** SHOTGUN BLAST ZOMBIE FALLS BACKWARDS AND WILL IMPACT FLOOR OR GROUND. PLACE IN AREA WHERE PADDED HEAD WILL NOT CAUSE DAMAGE OR PLACE ADDITIONAL PADDING ON GROUND AS NECESSARY.

**Optional Footpad Setup Instructions**

Follow steps #1 through #7 on initial installation first.

1. Connect the cable from the optional footpad to the jack labeled FOOTPAD located on the module.
2. Turn the switch on the base to the 'ON' position to enable FOOTPAD activation.
3. (Go to instruction 9 and continue setup) Step on FOOTPAD to activate the scary sequence.

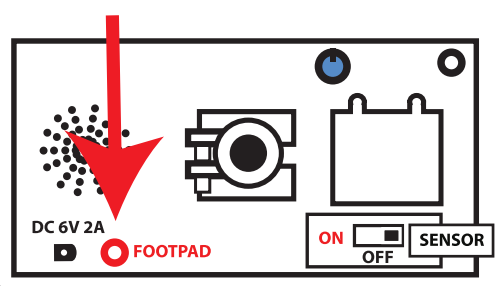

\*Footpads are sold separately and can be purchased at [www.tekkytoys.com](http://www.tekkytoys.com)

**Optional External Speaker Setup Instructions**

EXTERNAL SPEAKER IS NOT INCLUDED. MUST BE PURCHASED SEPARATELY.

1. Plug speaker cord into the jack labeled SPEAKER located on top of the **BASE**.
2. Use volume knob on external speaker to control volume levels.

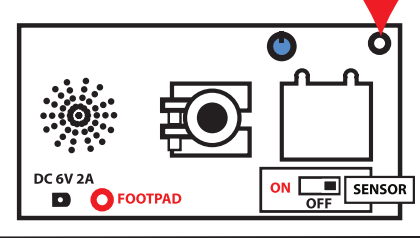

**BATTERY DIAGRAMS**

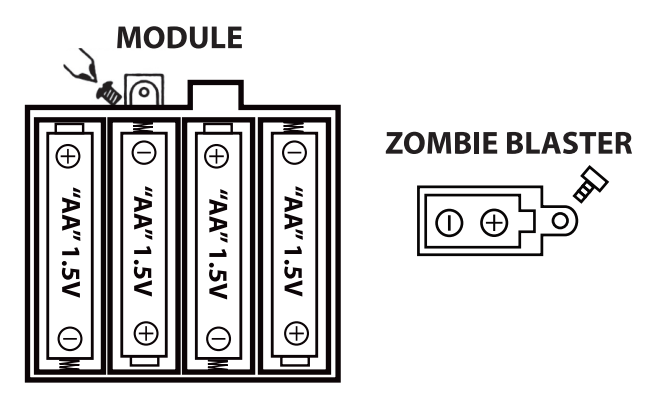

visit us at [tekkytoys.com](http://tekkytoys.com)  
Requires 4 'AA' Batteries(not included) or optional 6V 2A Adapter. (included)  
**Surface washable only.**  
ALL NEW MATERIALS:  
PLASTIC, POLYESTER,  
POLYESTER FIBER, POLYURETHANE FOAM

SHOTGUN BLAST ZOMBIE is a trademark of Tekky Toys.  
Copyright © 2015 Tekky Toys.  
All Rights Reserved.  
Made in China

**WARNING**  
DO NOT TURN ITEM ON UNTIL YOU HAVE COMPLETELY FINISHED ASSEMBLY.  
STAY CLEAR OF ITEM WHILE OPERATING.  
DO NOT PLACE ITEM ON UNEVEN GROUND.  
DO NOT PLACE WEIGHT ON ITEM WHILE IN OPERATION



**DO NOT RETURN THIS ITEM TO THE STORE!**  
If experiencing technical difficulties, please go to [www.tekkytoys.com](http://www.tekkytoys.com) for assistance.

**SMART PHONE SCAN SETUP VIDEO**

